



Note to Limited Edition Review:

As much of this review is similar to the standard kit review, those interested in just the limited edition differences will find them detailed under the heading 'Limited Edition Parts' near the end of this review. All the photos in this review are of the Limited Edition kit.

Background – the 'Dido' class:

The *Dido* class had their genesis in a letter written in 1933 by the Director of the Tactical Division, Captain Tom Phillips, to the Commanders in Chief of the Home and Mediterranean fleets asking for their opinions on a 4,000 ton cruiser to replace the aging 'C' and 'D' classes. At the time the Royal Navy was committed to building the *Leander* class for trade protection, the *Arethusa* class for fleet work, and the much larger *Towns* to respond to the threat of the Japanese *Mogami* class. To make up the numbers for fleet work, the Admiralty Board was looking for a cheaper alternative to the *Arethusas*.

CinC Mediterranean wanted a small cruiser that would be handy enough to work with the destroyer flotillas. It would have to be heavily gunned enough to deal with enemy destroyers and large enough to be used as a flagship and a rallying point for destroyer flotilla torpedo attacks. The *Town* class was much too large in his opinion to be useful in this role.

In 1934, the 'C' class cruisers *Curlew* and *Coventry* were converted to specialized Anti-Aircraft cruisers with 10-4" guns and 2-8 barrellled pompoms. Serving with the Mediterranean Fleet in 1935 during the Abyssinian crisis, these two ships were received very favourably and a requirement for heavy AA fire was added to the list for the new cruisers.

Further design refinements followed and by February 1935 requirements settled on a ship small enough to be built in large numbers, big enough to keep up with the fleet in heavy seas, maximum gun power, speed and handiness. As the *Arethusas* mounted 6-6" and 4-4" guns, a minimum of 10 guns was also required for the new design. The new 4.5" mounting had been adopted by the Admiralty as the standard AA gun, but they felt that this gun mount was too small for cruiser sized ships and settled on the new 5.1" Dual Purpose gun then under development

The development of the 5.1" gun morphed into the 5.25" gun which was also being proposed for the new King George V class battleships. This was not an ideal AA gun as the associated twin mounting was complex and heavy with a slow training speed and low rate of fire. It would however, prove to be a very good gun in its low angle role.

By June 1936 a cruiser of 5,300 tons mounting 10-5.25" guns was approved. The *Dido* class was born.

It should be noted that the *Dido's* were not single purpose AA cruisers like the converted 'C' class but merely small cruisers with a Dual Purpose main armament. The Admiralty still preferred the 4.5" gun for AA purposes.

To save time and effort, the basic hull of the *Arethusa* was used as the basis for the new design, with 3 gun turrets forward and two aft. The bridge had to be high enough to clear 'Q' mounting, which in turn meant the fore funnel had to be raked aft to reduce the effects of fumes. The after funnel and the masts followed suit. Tripod masts were chosen in order to minimize the number of stays which would interfere with fields of fire.

The original design called for a seaplane and crane between the funnels. This was replaced by two quad 2pdr pompoms in order to augment AA defence. Two triple torpedo mounts were also added.

For surface targeting, a Mk IV director was installed on the bridge. Two high angle directors for AA fire were fitted, one above the bridge and one aft of the mainmast, giving the ability to engage two aircraft simultaneously. The after HA director was dual purpose as it could also be used to engage surface targets.

The unit system of machinery was chosen with alternating boiler and engine rooms. A quadruple screw arrangement would drive the ships at 33 knots at 62,000 SHP and endurance was 5,000 nm at 16 knots. Four turbo-generators capable of generating 1,200 Kwh were also installed.

The armour scheme consisted of a 3" belt abreast the engineering spaces with a 1" deck and transverse bulkheads at the ends. A 2" platform deck covered the magazines which also had 1" longitudinal bulkheads fitted abreast. The turrets had 1" to 1.5" plate and the steering gear was enclosed with 1" sides and deck. This scheme was deemed sufficient to deal with 6" gun fire.

As much weight saving as possible was incorporated: welding of the forward sections, a reduced number of shells, copper piping, no handing room between the magazines and turrets, no spare gun barrels carried aboard, and lighter High Angle directors. The Mk II 5.25" mounting was chosen as it

featured combined magazines and shell rooms, saving weight and offering a reduction of some 60 crew members, no small consideration given the small size of the ships.

The following ships were ordered:

- Five in 1936: *Dido*, *Euryalus*, *Naiad*, *Phoebe*, *Sirius*
- Two in 1937: *Bonaventure*, *Hermione*
- Three in 1938: *Charybdis*, *Cleopatra*, *Scylla*
- Six in 1939: *Argonaut*, *Bellona*, *Black Prince*, *Diadem*, *Royalist*, *Spartan*

This was the largest cruiser program since the First World War. The class would be split into three groups: *Dido*, *Euryalus*, *Naiad*, *Phoebe*, *Sirius*, *Bonaventure*, *Hermione*, *Cleopatra*, and *Argonaut* built to the original design; *Charybdis* and *Scylla* armed with 4.5" guns; *Bellona*, *Black Prince*, *Diadem*, *Royalist*, and *Spartan* of a modified design with 4-5.25" turrets.

By 1939, none were ready due to bottlenecks with turrets, fire control equipment, turbines, and reduction gearing although the first ten had been laid down and six had been launched. In the spring of 1939, with *Bonaventure* about a year away from completion, a problem of supply of the 5.25" mounts arose as they had also been chosen as the secondary armament of the *King George V* class with the battleships having priority.

Compounding the problem was the pending order for five ships of the 1939 program. Partly as a result of the shortage of turrets and partly as a compromise to free up additional mountings and allow a sixth ship to be ordered in 1939, it was decided to complete *Charybdis* and *Scylla* with 4.5" guns instead. Known derogatively as 'The Toothless Terrors', *Charybdis* and *Scylla* were in fact true anti-aircraft cruisers.

Despite these measures, three of the first four to complete were one turret short: *Bonaventure*, *Dido*, and *Phoebe*, each mounting a single 4" star shell gun instead. *Bonaventure* carried hers in 'X' position; *Dido* and *Phoebe* in 'Q'. *Dido* would eventually receive her 5th turret, *Phoebe* never would, and *Bonaventure* would be lost before receiving her 5th turret. All the remaining ships completed with the full outfit of turrets.

Construction of the six ships of the 1939 group was suspended in 1940. All were subsequently restarted, but only *Argonaut* was completed to the original design. The other five were completed to the modified design featuring only 4-5.25" twin mounts, a lower bridge, and upright funnels and masts.

Of the original two groups, *Bonaventure* was the first to complete in May 1940; *Argonaut* was the last in August 1942. The third group completed from August 1943 (*Spartan*) to January 1944 (*Diadem*). All of the ships completed with some form of radar, and by 1943 surviving ships all had types 272, 281, 282, 284, and 285 installed.

As first of type, *Bonaventure* was subject to extensive trials, complicated by troubles with the 5.25" mounts which took Vickers 3 weeks to correct. In all other respects the ship was deemed satisfactory.

Bonaventure suffered weather damage in November 1940 which buckled two pillars under the forward deck; this was solved by additional stiffening. *Naiad* had movement in the deck and bridge which caused leaking; deck movement in other ships resulted in frequent jamming of 'A' turret.

It was determined that most damage was caused by driving them too hard in bad weather. As experience was gained during operations, crews were able to allow for adverse weather conditions with the result that no further weather damage was reported.

Overall, the ships were good sea boats but prone to heavy pitching, mainly due to the heavily loaded ends. They were less successful in the AA role than the 4" armed 'C' class, mainly due to the heavy and slow 5.25" gun mount.

Many modifications were made to the close range AA armament during the war, references and photographs should be consulted. Camouflage schemes also varied considerably, references should be checked carefully.

They were used extensively mainly in the Mediterranean where they gave good service in the face of constant air and submarine attack. Five of them were sunk, four to torpedoes in the machinery spaces: *Naiad*, *Bonaventure*, *Hermione*, and *Charybdis*. With the lack of reserve buoyancy on such a small hull it is not surprising that flooding in the large machinery spaces would cause the loss of the ship. *Spartan* was lost after being hit by a glider bomb.

In addition 6 of the ships were very heavily damaged from bombs, torpedoes, or shellfire. *Phoebe* and *Argonaut* were torpedoed twice and *Cleopatra* once, *Cleopatra* managing to survive a torpedo hit in the machinery spaces. *Phoebe* and *Argonaut* were fortunately (!) hit elsewhere on the hull. *Scylla* was not fully repaired after being mined off Normandy. *Dido* and *Sirius* were both heavily damaged by bomb hits. *Cleopatra* was also damaged by bombs and a 6" shell hit from the Italian battleship *Littorio*.

The Kit:

This features *Naiad* as built in her original fit as a member of the first group of *Dido*'s.

Packaging:

This limited edition kit is the standard *Naiad* kit with extra metal pieces, 2 additional photo-etch sheets, and a spool of rigging thread. It comes in a well-constructed box featuring a dramatic painting of *HMS Naiad* in action wearing a colourful camouflage scheme. Only 1,000 of the limited edition kits are being made, the bottom of the box has a special sticker with the unique kit number.

Inside the main box can be found two smaller boxes: a see-thru one containing the two sprues for the masts, and another very solid box with the rest of the kit components. Each of the sprues is individually

sealed in plastic bags, with the exception of the main superstructure pieces which are in their own sealed box. The limited edition metal parts are in their own plastic box.

There is also a large full colour card featuring the box art on one side and a ship's history with general characteristics on the reverse.

The box can be used as a display base by carefully cutting and folding the box top so that it forms a backdrop for the completed model which would rest on a blue sea scape that comes as an inner flap. Directions for this interesting feature can be found on the instruction sheet.

The kit comprises 256 parts on 20 sprues with a further 86 photo-etch pieces. The limited edition adds 46 metal parts and 364 photo-etch pieces.



---- Box Art ----



---- Limited Edition Sticker on bottom of box ----



----- Internal box, clear box for masts, extra metal parts, and extra photo-etch -----



----- Contents of internal box -----

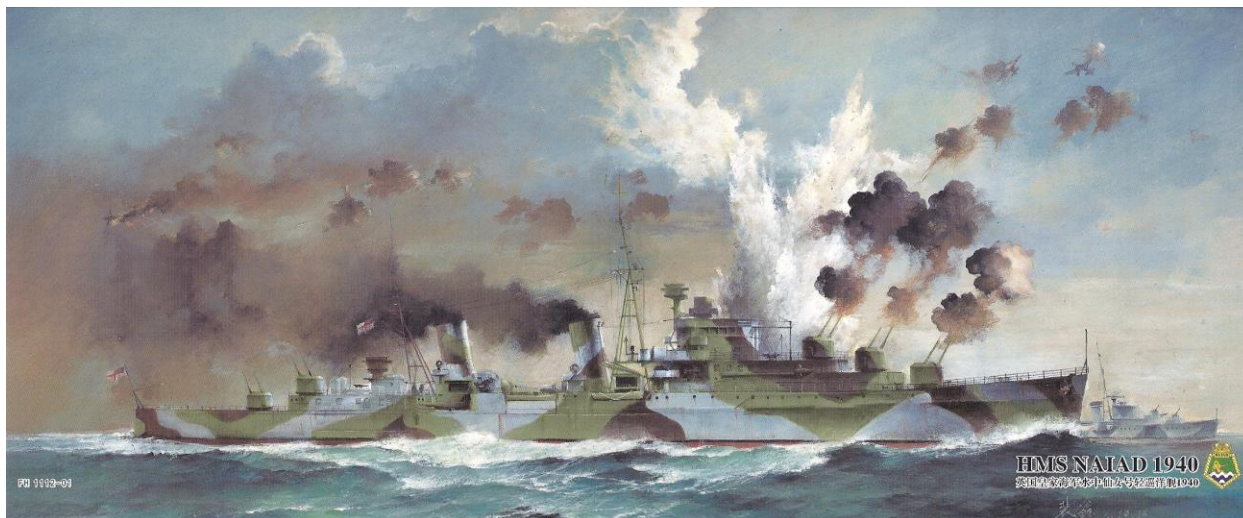

HMS Naiad belongs to Dido class light cruiser, which is the first kind of cruiser designed as the main role of fleet air defense. She was built for fighting against increasing air threat by British Navy on the eve of World War II.

Dido class light cruiser was equipped with 133mm dual-purpose guns as her main weapon which are with powerful anti-aircraft capability but low cyclic rate. Hence she was also armed with some short range anti-aircraft weapons such as Quad pom-pom guns and 12.7mm machine guns. As the war progressed, some ships of this class were equipped with massive middle range and short range anti-aircraft weapons.

There were totally 11 Dido class light cruisers ever built, most of them were named after characters of Greek and Rome myths. HMS Naiad is from the fairy of Greek myths which is the symbol of rivers, lakes, streams, springs and also well water. She is called "Ναϊάδς" in Greek.

HMS Naiad was built in Hawthorn Leslie shipyard. She was launched on February 3 1939, and commissioned on July 24 1940. At that time, WW II had broken out. She joined the home fleet to protect trade ships at first. Soon she participated in the operation of searching German pocket battleship "Admiral Scheer" in November, 1940. During December and January of the next year, she escorted ship group to Freetown in Sierra Leone. By the end of January 1941, she returned to northern territory waters of Britain where she discovered Sharmorst and Gneisenau which intended to break into Atlantic and launch the "Operation Berlin". In May 1941, she joined convoy operation in Malta of Mediterranean and then took part in the "Battle of Crete", where she was seriously hurt by German planes.

On March 11 1942, HMS Naiad was attacked by German submarine U-565 when she returned to southern Crete Island. She was finally sunk and 77 sailors were killed.

水中仙女号属于狄多级轻巡洋舰，这是世界上第一种设计即以舰队防空为主要职责的巡洋舰，是英国皇家海军在二战爆发前夕，为对抗日益扩大的空中威胁建造的。



狄多级轻巡洋舰装备了高平两用的133毫米炮作为主要武器，具有较大的对空打击威力，但射速不够快，同时安装了英国军舰常用的乒乓炮和12.7mm机枪等近距离防空武器，随着战争的进程，同级军舰在战争后期加装了大量中、近距离的对空武器。

狄多级轻巡洋舰共建造11艘，大多以希腊、罗马神话中的人物命名，水中仙女号的舰名来自希腊神话中象征江河、湖泊、溪流、山泉乃至水井的仙女，希腊语称为奈阿得斯。

水中仙女号由霍森莱斯利船厂建造，于1939年2月3日下水，1940年7月24日完工服役。该舰服役时二战已经爆发，最初她加入了本土舰队，用以保护贸易船队。1940年11月参加了搜寻德国袖珍战列舰舍尔海军上将号的行动，12月及来年的1月她护送船队去塞拉利昂的弗里敦，在1941年的1月末她返回了英国北部水域，在那里她发现了正要闯入大西洋及科伦斯“柏林”行动的沙恩霍斯特号和格罗森德号，1941年3月水中仙女号参加了在地中海的土耳其护航行动，还参加了克里特岛的行动并被德国飞机重创。

1942年3月11日，水中仙女号在返航途经克里特岛南部的时候遭到德国潜艇U-565的袭击并被击沉，77人丧生。

General characteristics		主要性能	
Standard displacement: 5450 tons	Weapons:	标准排水量: 5450吨	武器:
Length: 156.06m	133mm dual-purpose guns x 5	全长: 156.06m	双联装133mm高平两用炮x5
Beam: 15.39m	Quad 2odr.pom.pom guns (40mm) x2	宽: 15.39m	四联装8磅乒乓炮(40mm) x2
Draft: 5.1m	Quadruple 92.7mm anti-aircraft machine guns x2	吃水: 5.1m	四联装12.7mm高射机枪x2
Complement: 490	Single Hotchkiss 3pdr gun (47mm) x1	定员: 490人	单装哈奇基斯3磅速射炮(47mm) x1
Maximum speed: 32.25 knots	583mm Triple Torpedo x2	最大航速: 32.25节	三联装533mm鱼雷x2
Endurance: 5500 nautical miles /16 knots		续航力: 5500海里/16节	

1/700 FH 1112



---- Front and Rear of included card ----

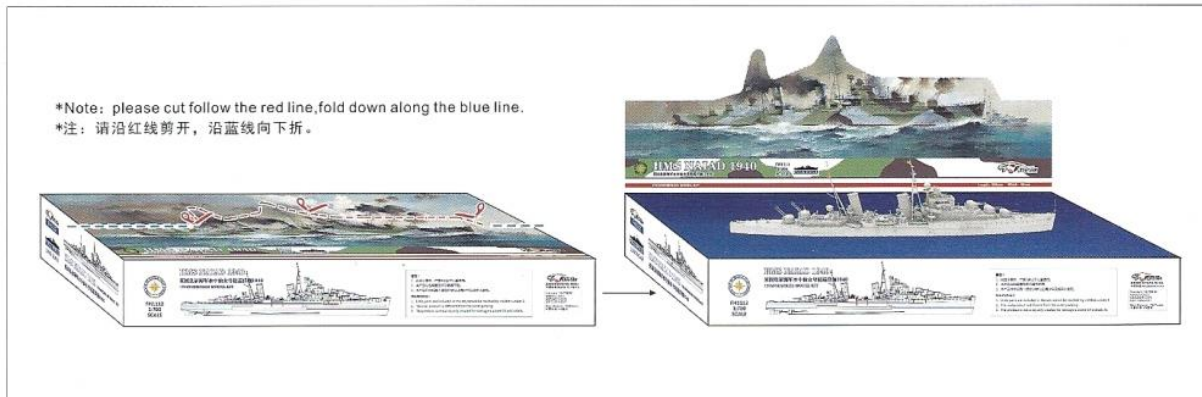

HMS NATALAD 1940
英国皇家海军中仙女号驱逐舰1940
UNASSEMBLED MODEL KIT

Dear customers. Thanks for choosing flyhawkmodel. If you find any part missing or some other problems. Please contact us (E-mail: flyhawkmodelxc@vip.163.com. QQ: 1354377829). We'll deal with your problems as soon as possible.



尊敬的顾客, 感谢您购买鹰翔模型。如果您在这套模型中发现缺件、注塑不全等情况, 请和我们的客服联系 (E-mail: flyhawkmodelxc@vip.163.com. QQ: 1354377829), 我们将尽快为您处理, 因此造成的不便我们深感抱歉。

FH 1112 Page-4

Copyright © 2014
All Rights Reserved By Flyhawk Models

----- How to use the box to create a display -----

Hull:

The starboard and port hull sides are in one piece and scale out perfectly to the actual length of 512 feet. A lower hull and a waterline base plate and weight are supplied giving the modeller the option to build either a full hull or a waterline version. There are no stands included so those wishing to build the full hull version will need to come up with some arrangement to display the completed model.

The lower hull itself has finely molded bilge keels and the lower half of the armour belt. Rudder, propellers and shafts are included as separate pieces.

The pronounced bow knuckle is in the correct position, starting just under 'B' barrette and terminating just short of the bow. It correctly follows the contour of the upper deck, but curves slightly upwards under 'A' barrette. This is not quite the correct shape as careful study of many photographs shows that the actual knuckle was a straight line for its entire length without any curve. Nevertheless, this is a very good attempt at capturing this very distinctive feature; most people will not even notice the discrepancy.

There is also a good attempt at capturing the line of hull plating from the bow back to the armour belt amidships and from the armour belt aft to the stern. It is slightly exaggerated in this scale and could be sanded down to be less conspicuous. The armour belt itself is spot on as is the external degaussing cable. The portholes all feature 'eyebrows'.

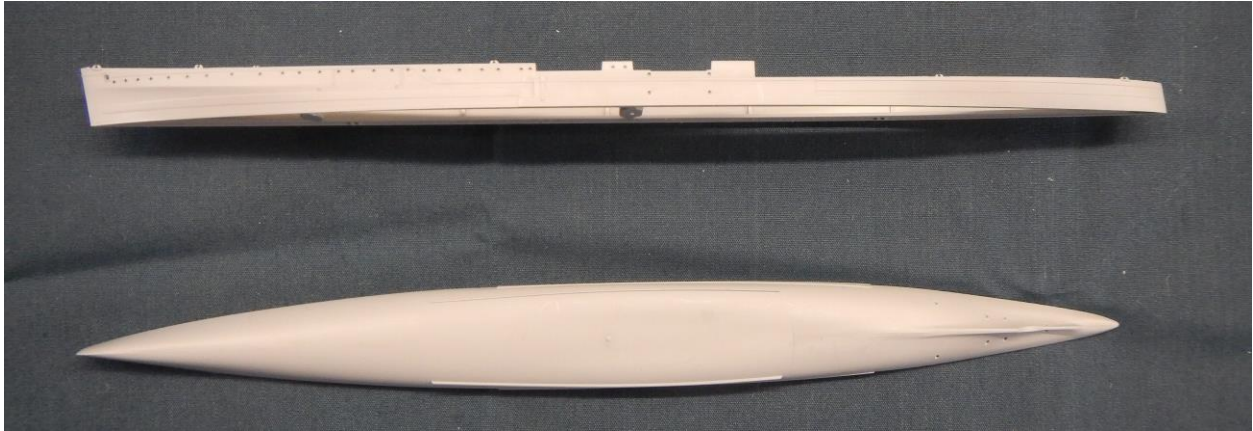

----- Upper and lower hulls -----

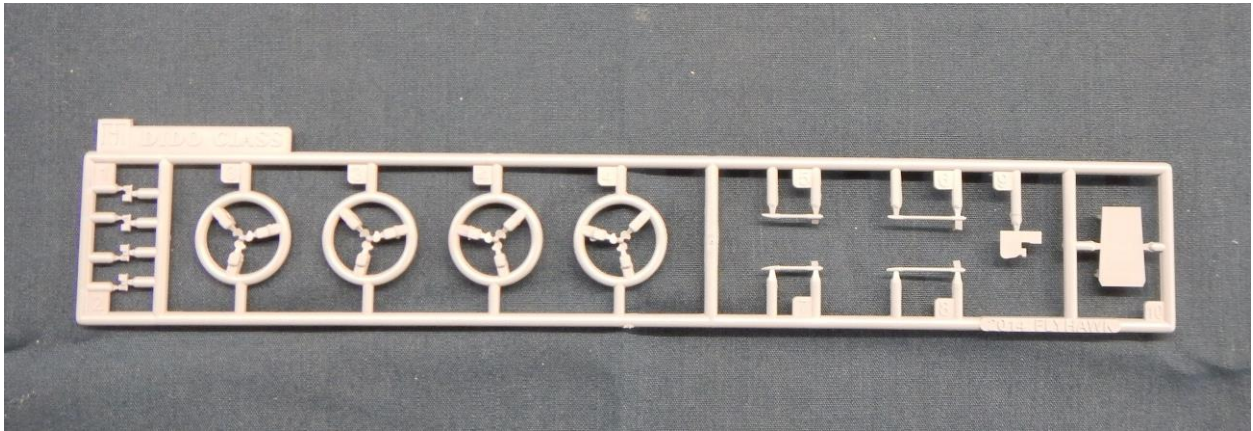

----- Propellers, rudder, and propeller shafts -----

Decks:

The main decks are in two pieces: the foredeck back to the focsle break, and the after deck. Both feature amazing levels of detail with individual deck planks, bollards, capstans, boat skids, and hatches. The main deck forward of the breakwater features an intricate non-skid pattern. The breakwater itself is a separate piece. Both decks drop right into place on the main hull in a good display of precision fitting.

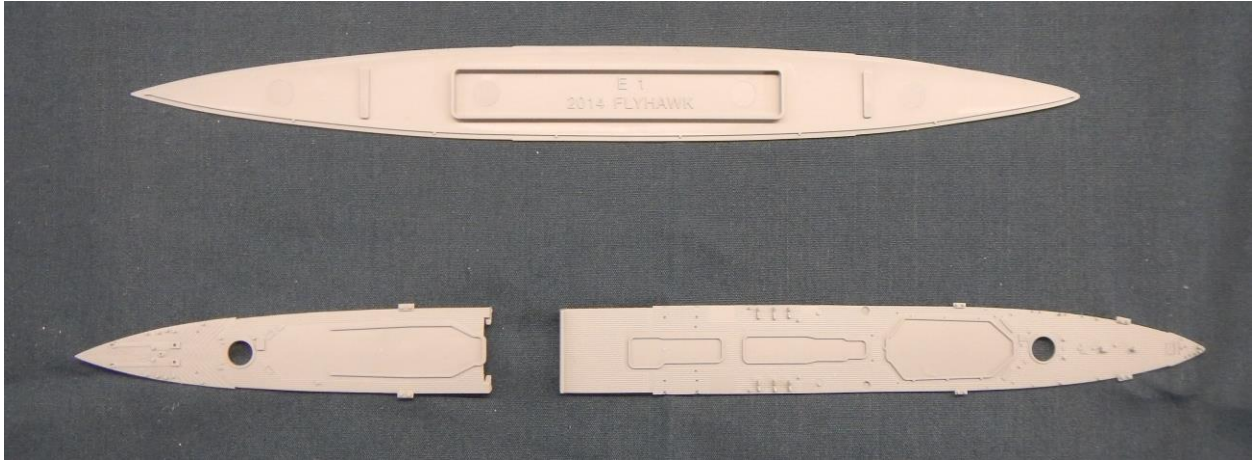

----- Waterline hull plate and main decks -----

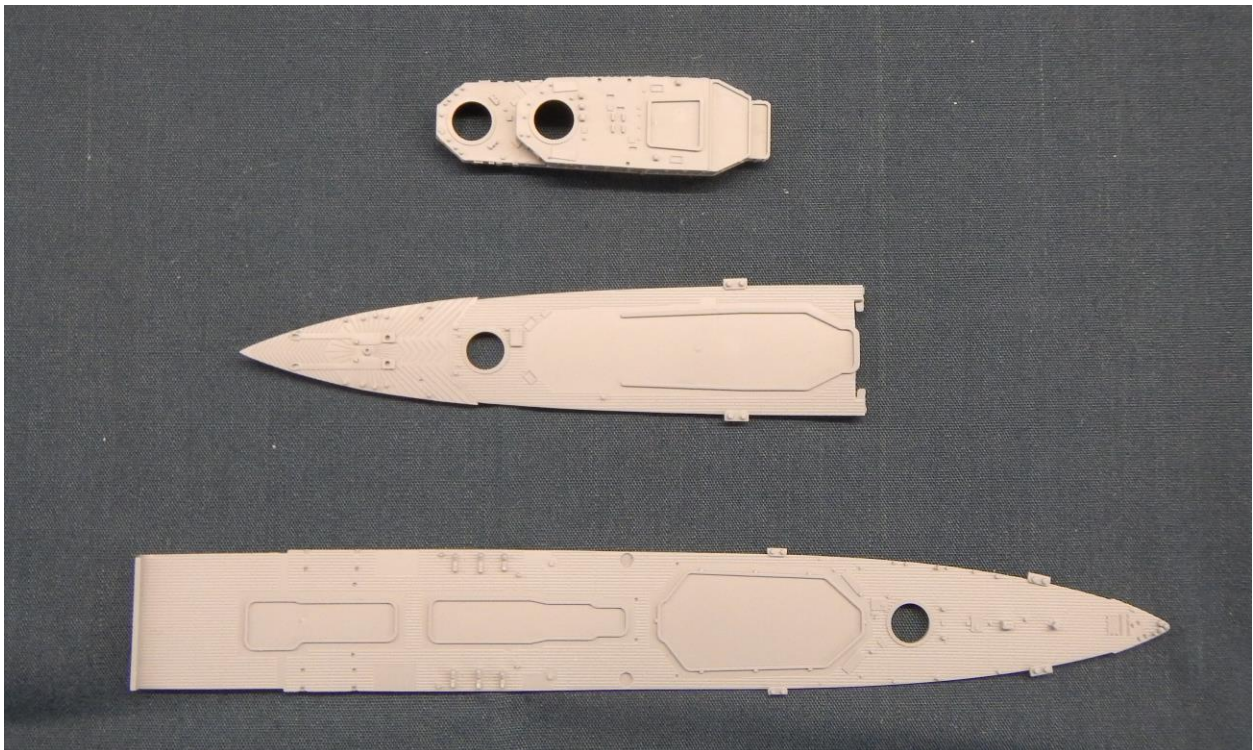

----- Forward superstructure and main decks showing the amount of detail -----

Superstructure:

The main superstructure parts are all individual pieces that do not require cutting from sprues. This is a great feature which prevents any damage from sprue cutters and the like. They all feature immense detail on every face: hatches, handrails, deck fittings, slots for fitting other pieces. The one piece bridge is especially outstanding featuring molded in air deflectors and the open bridge windows below the

upper bridge. There are no less than 17 pieces to be applied to the upper bridge, including binoculars, the chart table cover, and the main gunnery director. The forward HA control station above the bridge consists of 4 pieces and has a simulated canvas cover.

The funnels are single pieces with engraved lines, separate caps, steam pipes, and piping for the whistles.

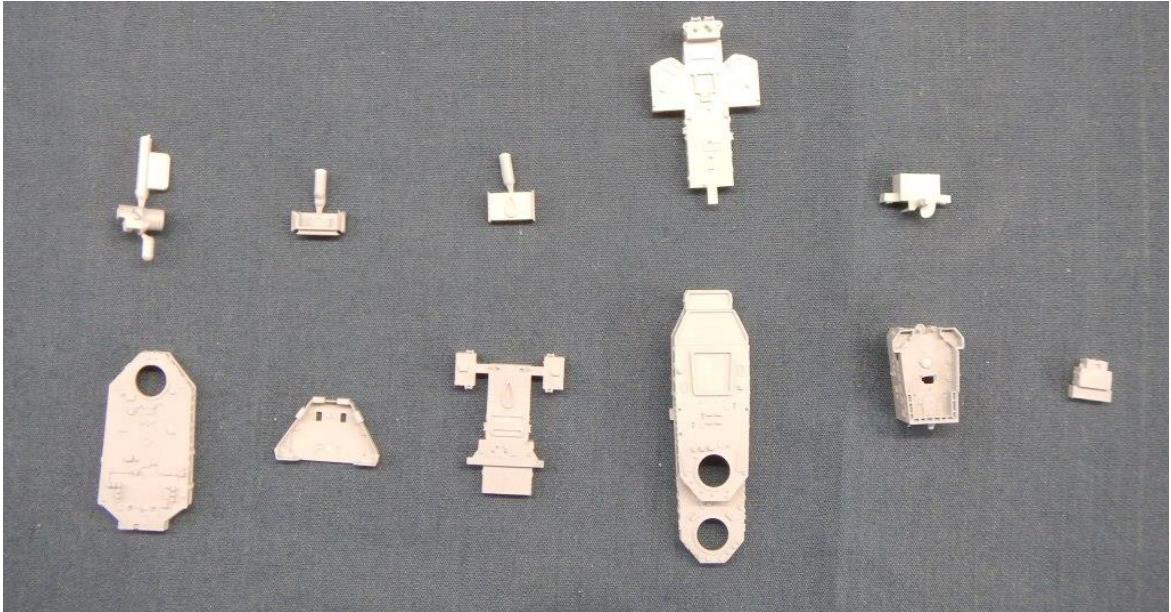

----- Superstructure pieces -----

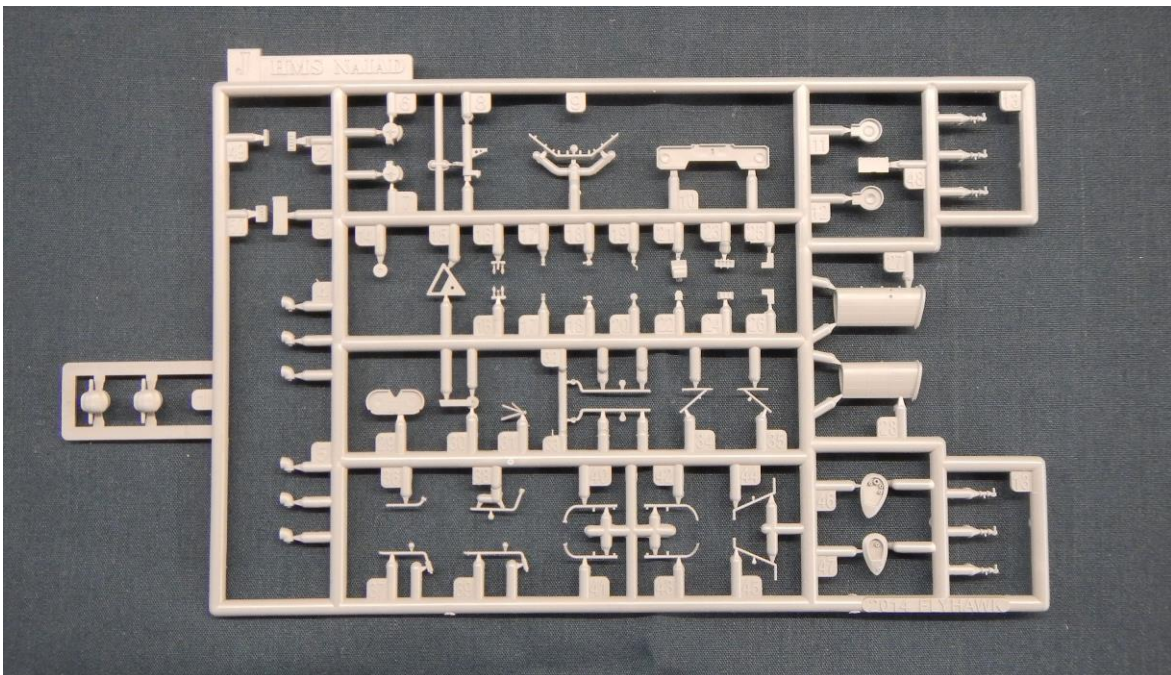

----- Funnels and smaller fittings -----

Weapons:

The main 5.25" gun turrets are in two pieces, with separate gun barrels. The turrets are outstanding, correctly shaped with plenty of roof and side details. Photo-etch pieces for the gearing used to elevate the guns are provided if the modeller desires to have the guns at full elevation.

The quad pompoms consist of 3 pieces and have plenty of detail on the actual gun platform.

The 0.5" mounts are also very detailed.

The torpedo tubes are exquisite with plenty of detail and hollowed out ends allowing torpedoes to be inserted if the modeller wishes. Torpedoes would have to be scratch built.

There is an additional open single gun mount to be placed just forward of 'X' turret. I haven't been able to find a photo showing this gun or a reference that mentions it. Those in pursuit of absolute accuracy may need to consult their references to see if this gun mount was ever actually mounted.

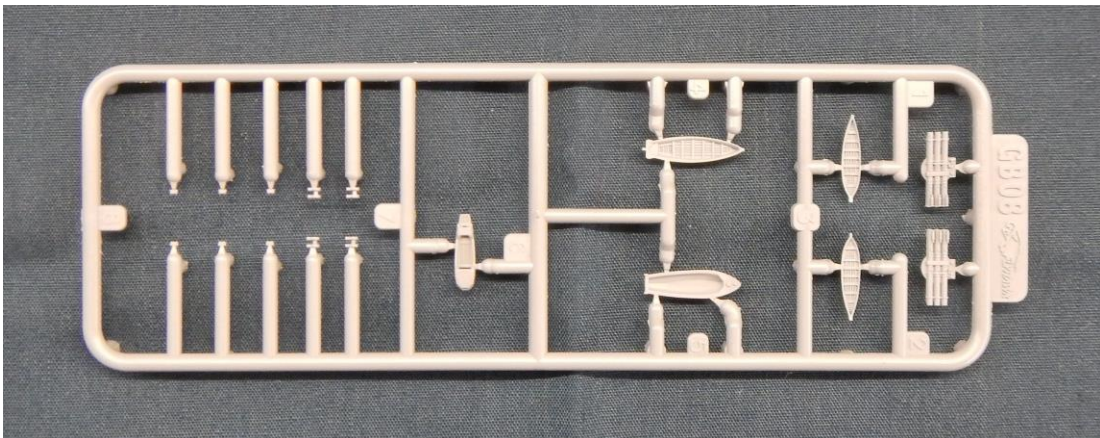

----- Torpedo tubes and boats -----

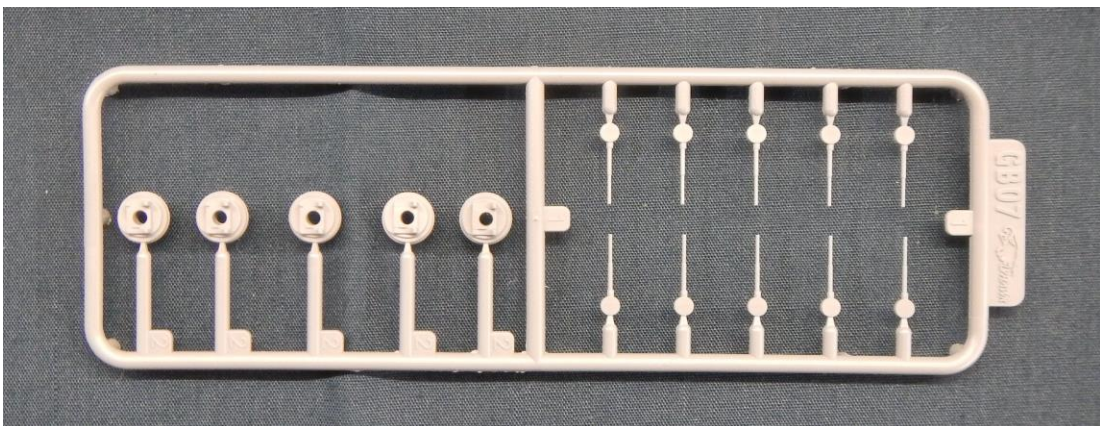

----- 5.25" turret bottoms and gun barrels -----

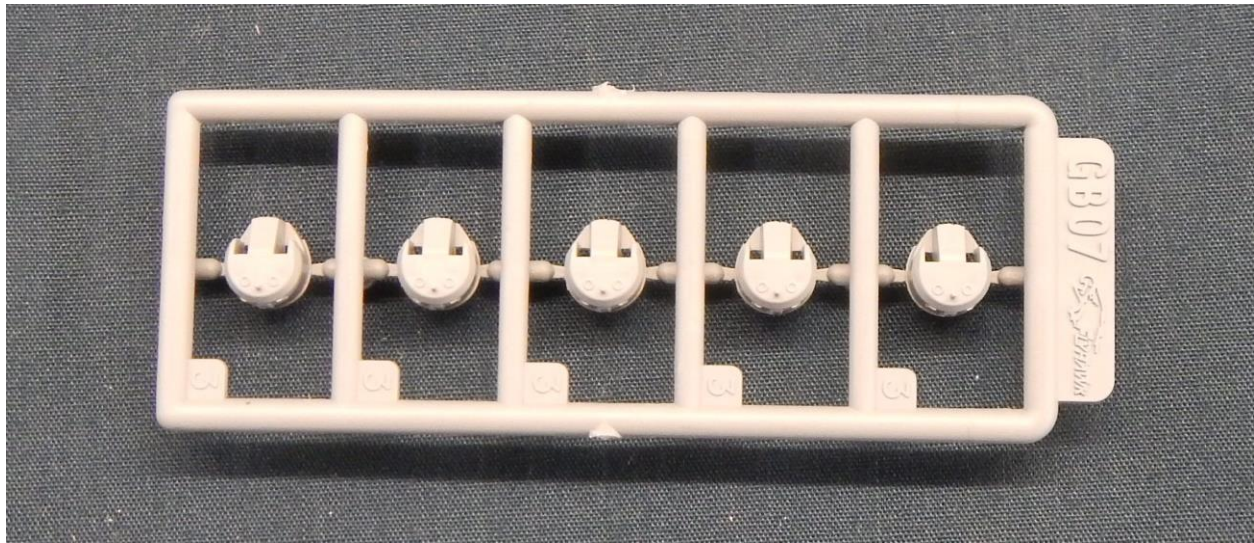

----- 5.25" turrets -----

Boats and fittings:

There are 3 open boats and one motor launch, each one features deck planks. There are many smaller fittings, every piece of which is incredibly detailed. The ready use ammo lockers have doors, the cowl vents are hollowed out, the main air intakes have photo-etch grills, the deck winches have detailed motors, the life rafts are detailed both top and bottom, the davits are extremely thin, the paravanes are accurately shaped, and there is a depth charge rack and a smoke float rack for the quarterdeck.

Photo-etch railings are supplied pre-cut to the correct lengths with very clear instructions on where each piece is to be placed.

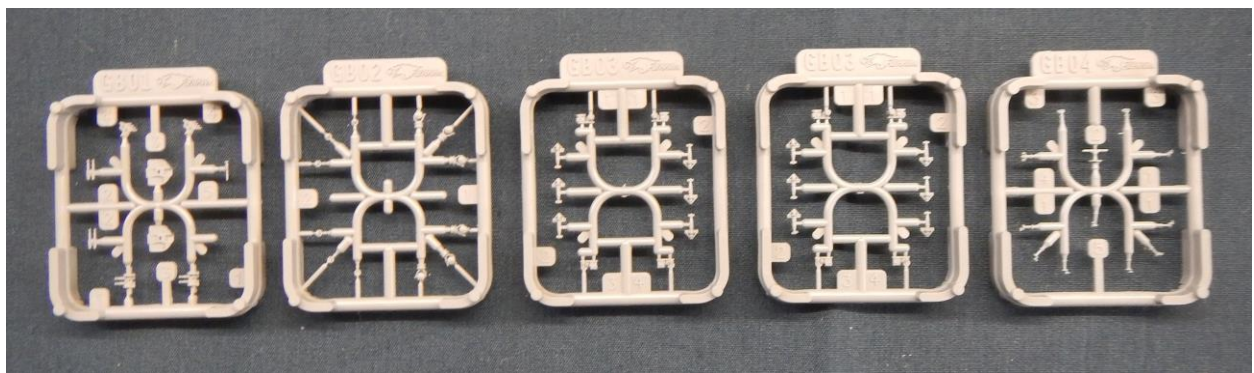

----- Fittings -----

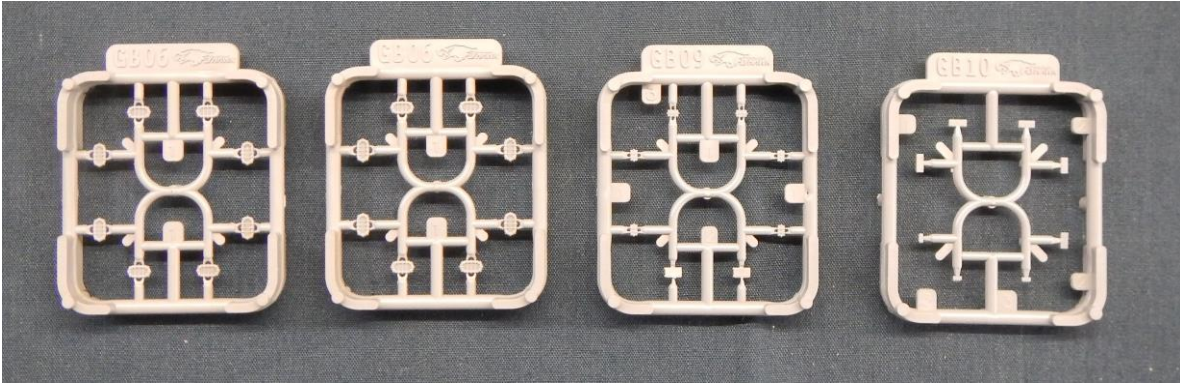

---- Fittings ----

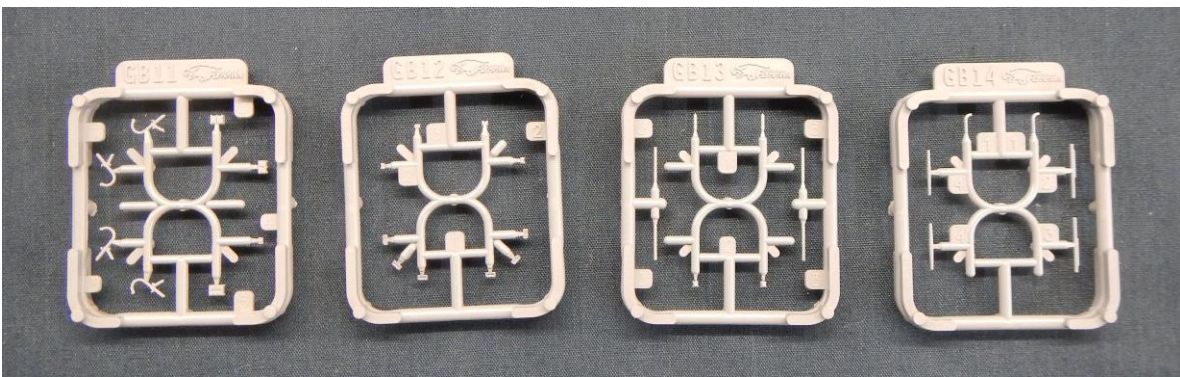

---- Fittings ----

Masts:

The masts and tripod supports come on their own sprues and are packaged separately in their own box. They are extremely thin and can be used as is without resorting to replacements built from wire. Photo-etch aerials for the Type 279 radar and platform are supplied for the tops of both masts.

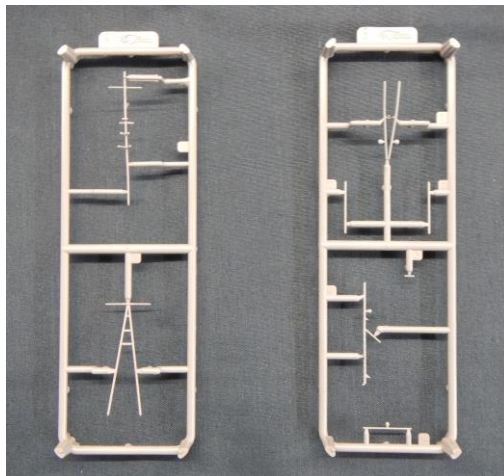

---- Masts ----

Decals:

As Royal Navy cruisers did not carry pennant numbers as a rule, the decals are very minimal consisting solely of 4 White Ensigns.

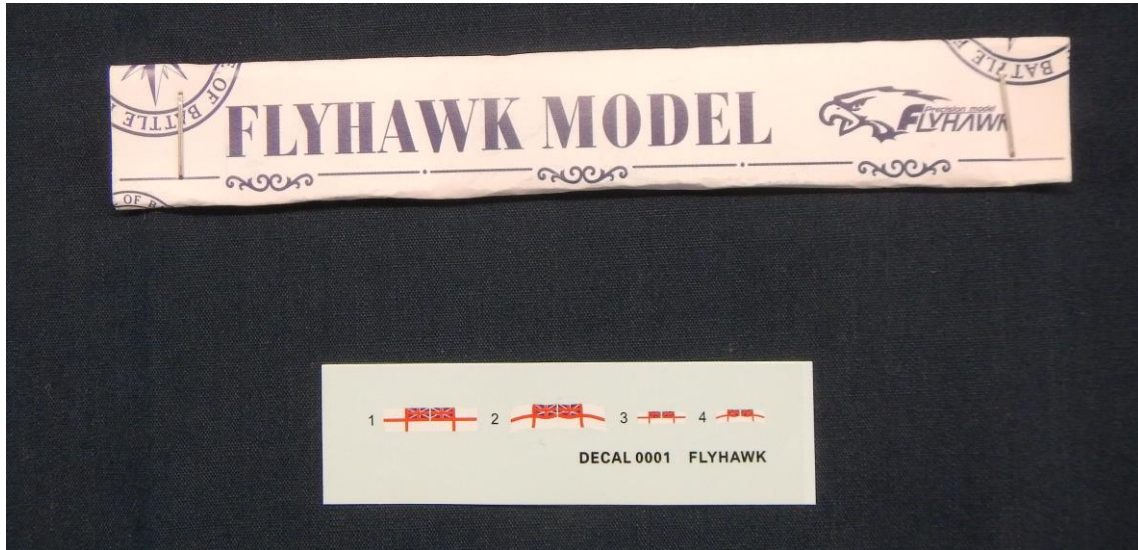

----- Weight and Decals -----

Photo-Etch:

A very comprehensive photo-etch sheet is also included with all the railings, ladders, grilles, lattice supports, and radar components needed for the kit. It also contains anchor chain and some smaller structures such as the chart table shelter and a storage locker.

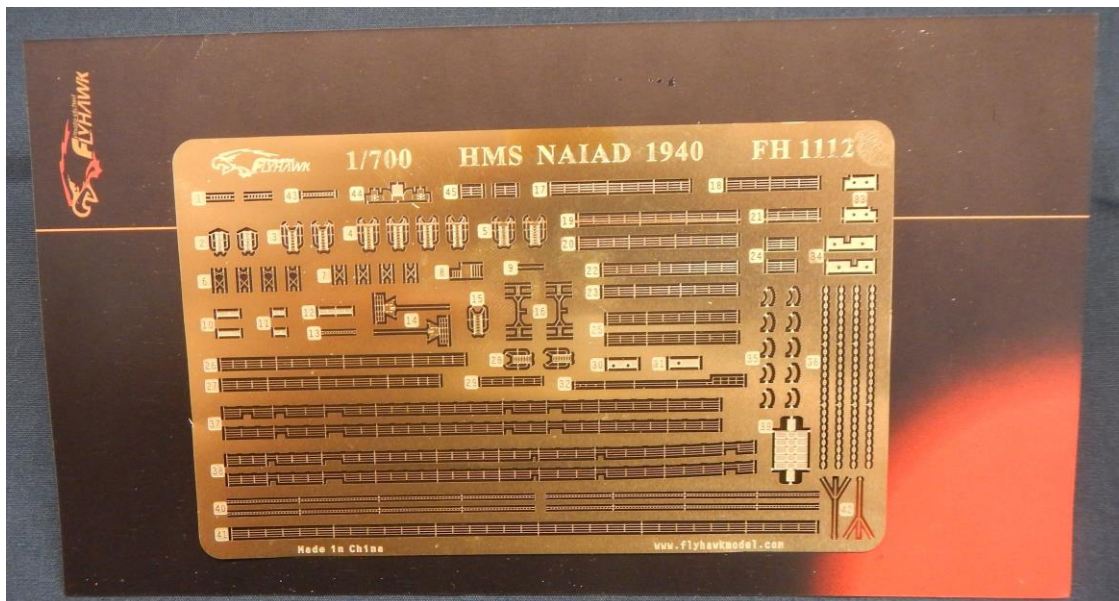

----- Photo-etch sheet -----

Instructions:

The instructions come on two large, double sided full colour pages. They are very clear and comprehensive and also feature a drawing showing all the sprues and parts included. Flyhawk uses colour coding to assist with placement of smaller parts; this is a very good feature which takes out a lot of guess work.

READ BEFORE ASSEMBLING 组装前必读

- Please check out the instruction before assembling.
- Glue and paint are not included.
- Glue, paint and other tools are not allowed to be reached by children.
- Please take care while using tools, glue and paint should be kept away from fire and be sure not working with models in confined chamber.
- The suite may contain metal parts, please be careful while working.

- 组装前请仔细阅读说明书。
- 本套件不含胶水和油漆。
- 胶水、油漆、工具等不可让小孩接触。
- 使用工具时请注意安全，胶水和油漆请勿靠近接触火种，请勿在密封的地方制作模型。
- 套件中可能附带金属零件，请小心制作。

ICON INSTRUCTION 图例

BE CAREFUL! ATTENTION! ATTENTION! ATTENTION!	READ INSTRUCTIONS! ATTENTION! ATTENTION! ATTENTION!	BE CAREFUL! ATTENTION! ATTENTION! ATTENTION!	BE CAREFUL! ATTENTION! ATTENTION! ATTENTION!	BE CAREFUL! ATTENTION! ATTENTION! ATTENTION!	BE CAREFUL! ATTENTION! ATTENTION! ATTENTION!	BE CAREFUL! ATTENTION! ATTENTION! ATTENTION!	BE CAREFUL! ATTENTION! ATTENTION! ATTENTION!

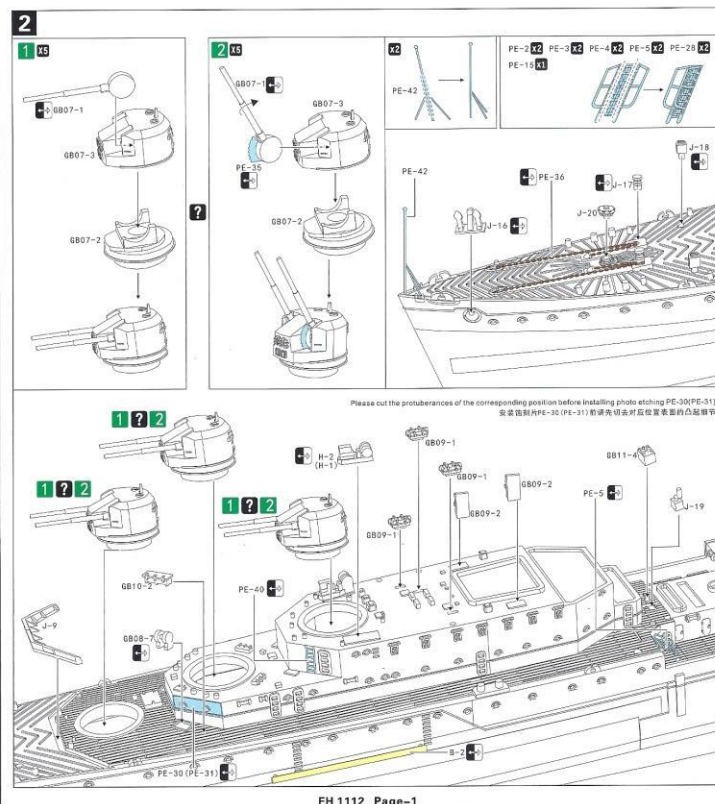
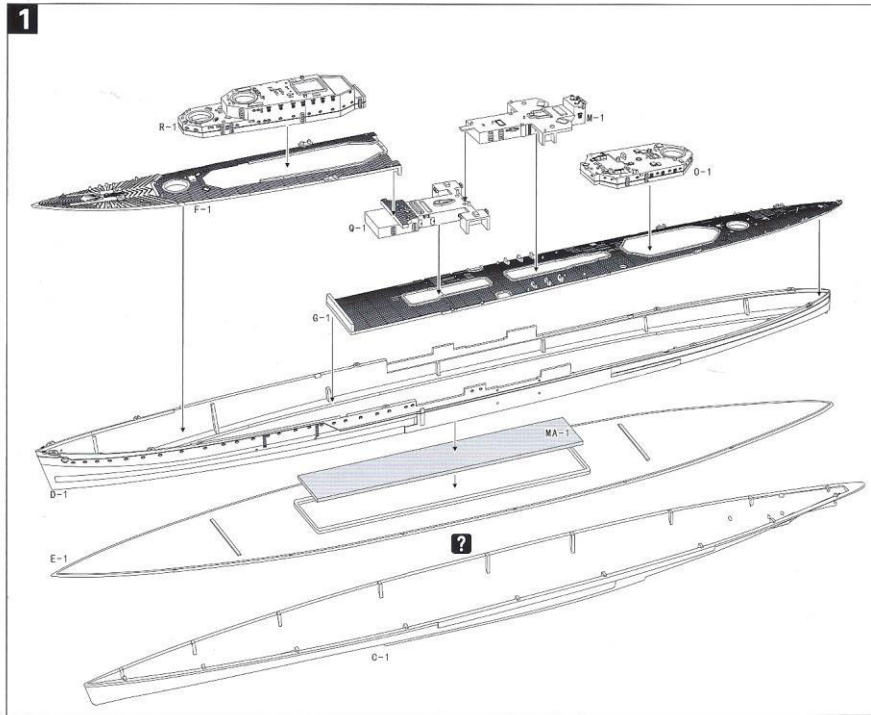

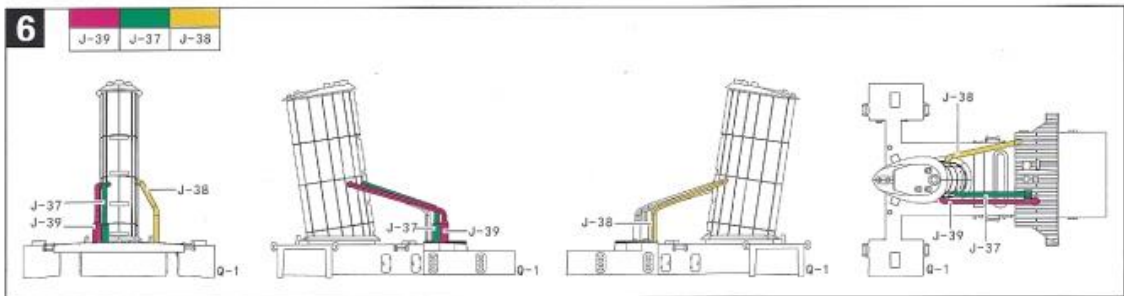
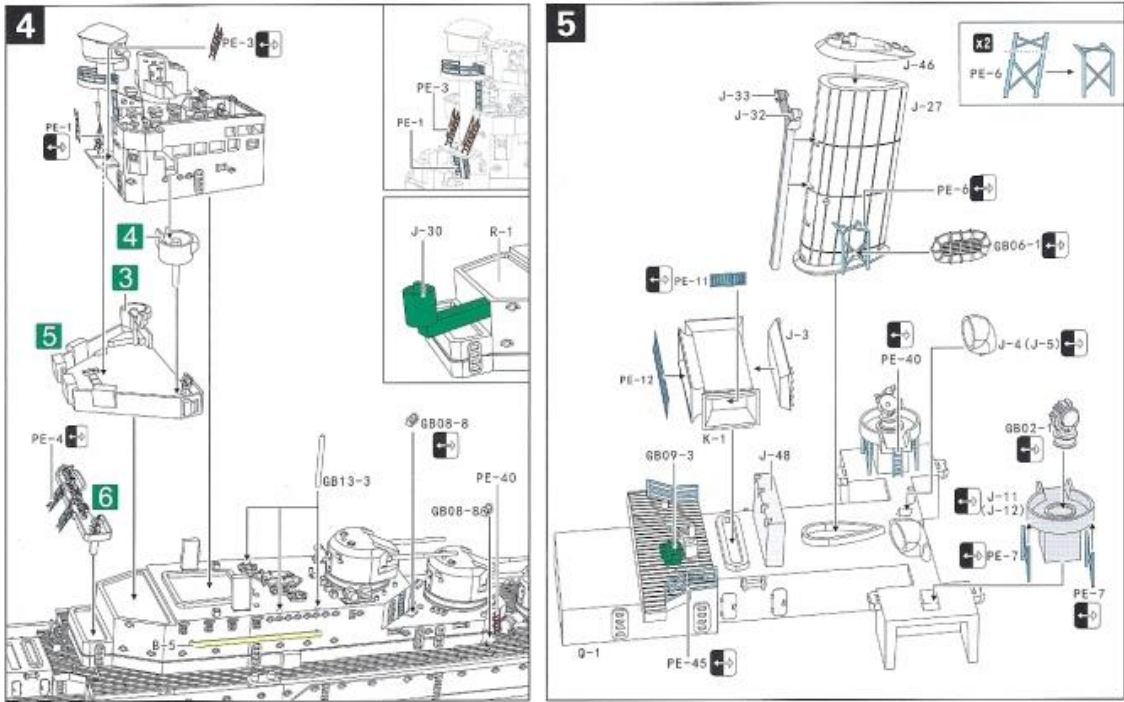
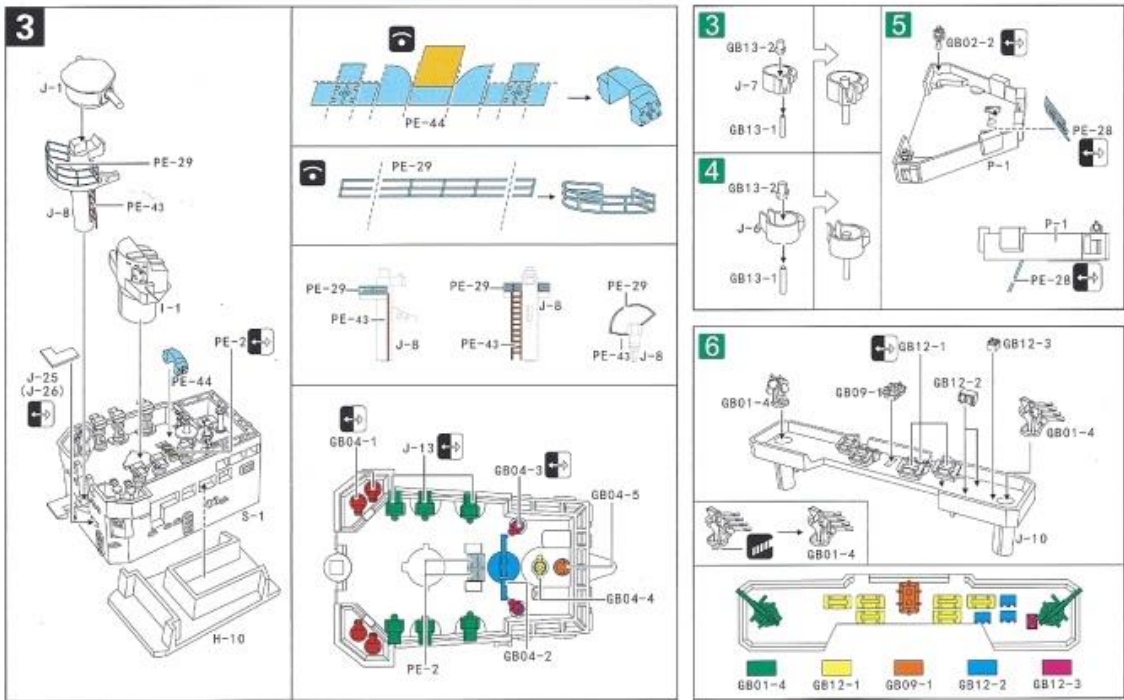

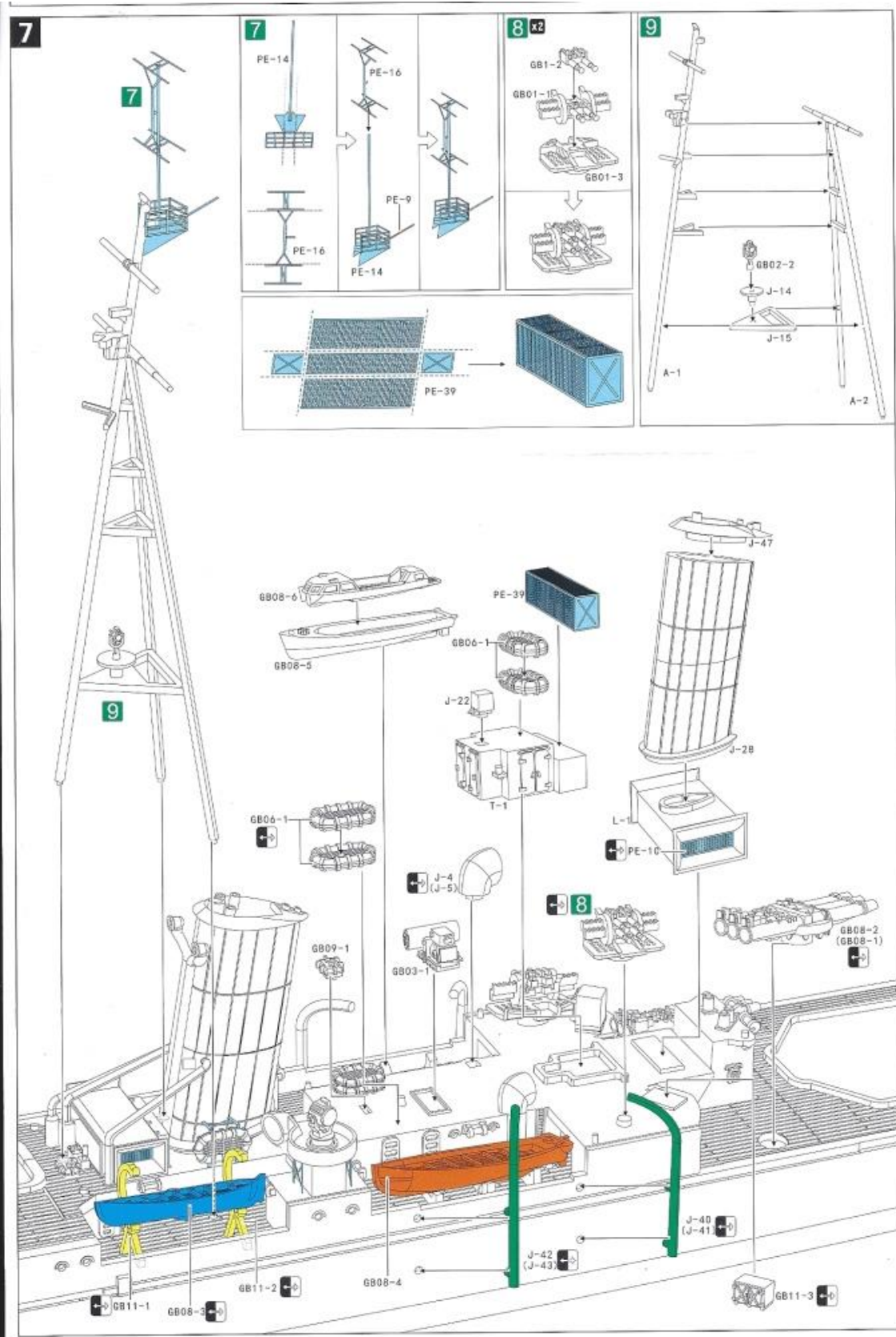

10

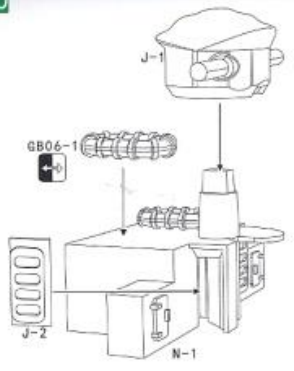

11

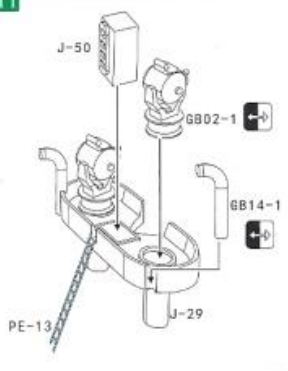

12

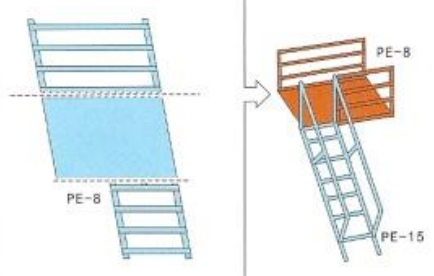

8

Please cut the protuberances of the corresponding position before installing photo etching PE-34(PE-33)
 安装蚀刻片PE-34 (PE-33)前请先切去对应位置表面的凸起部分

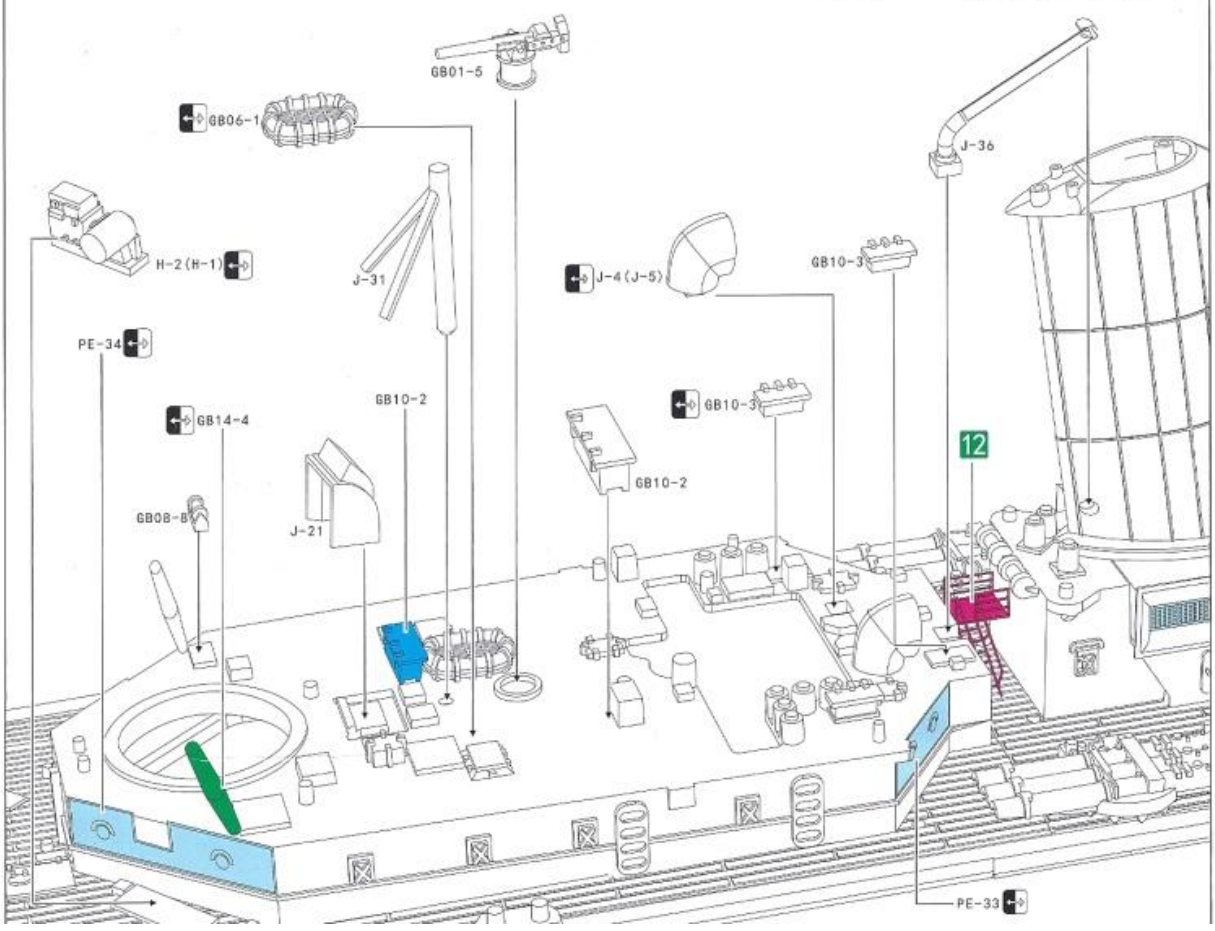

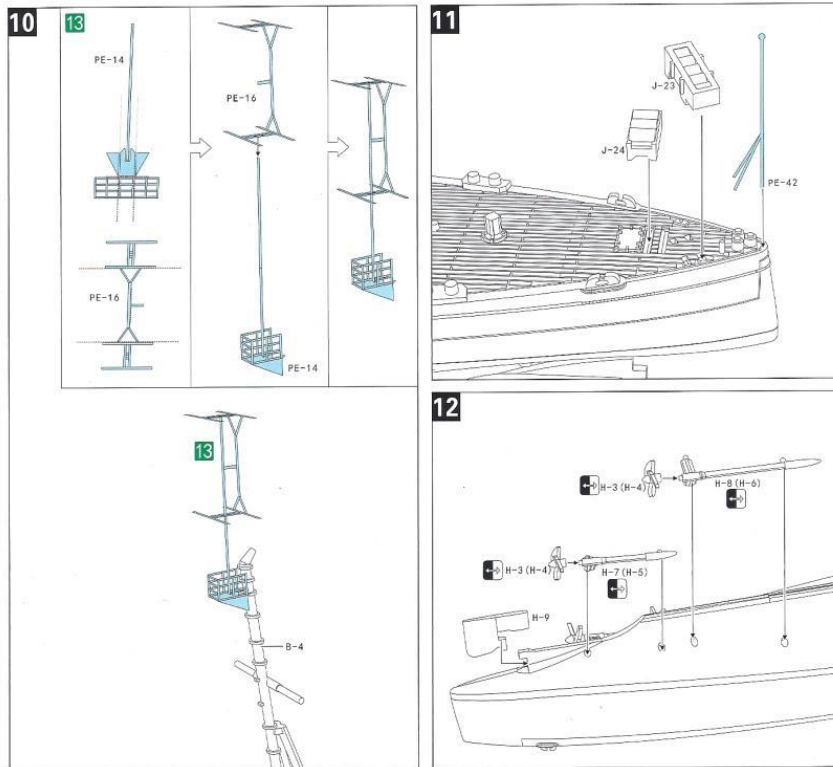
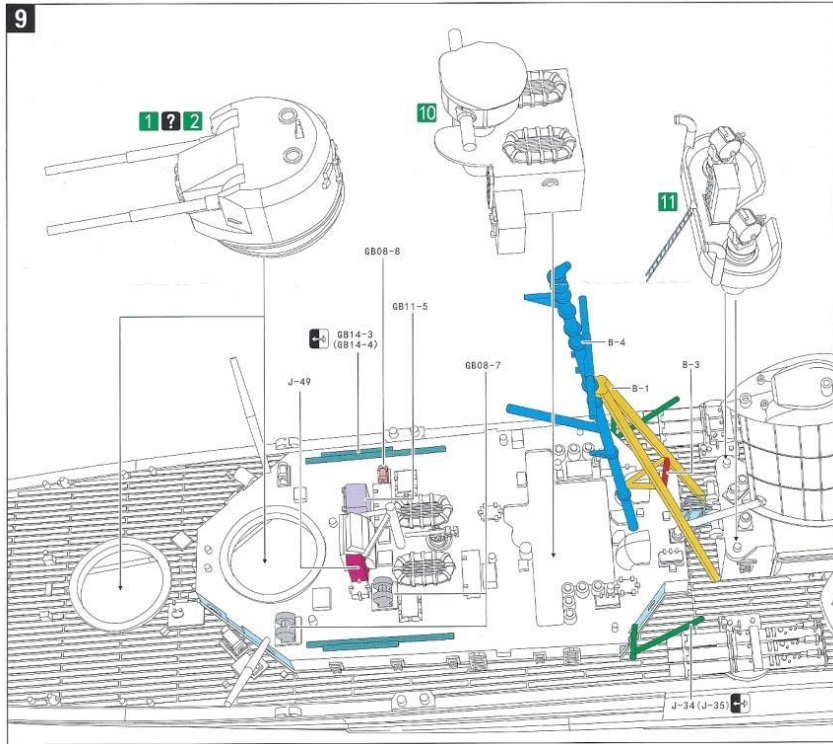

13

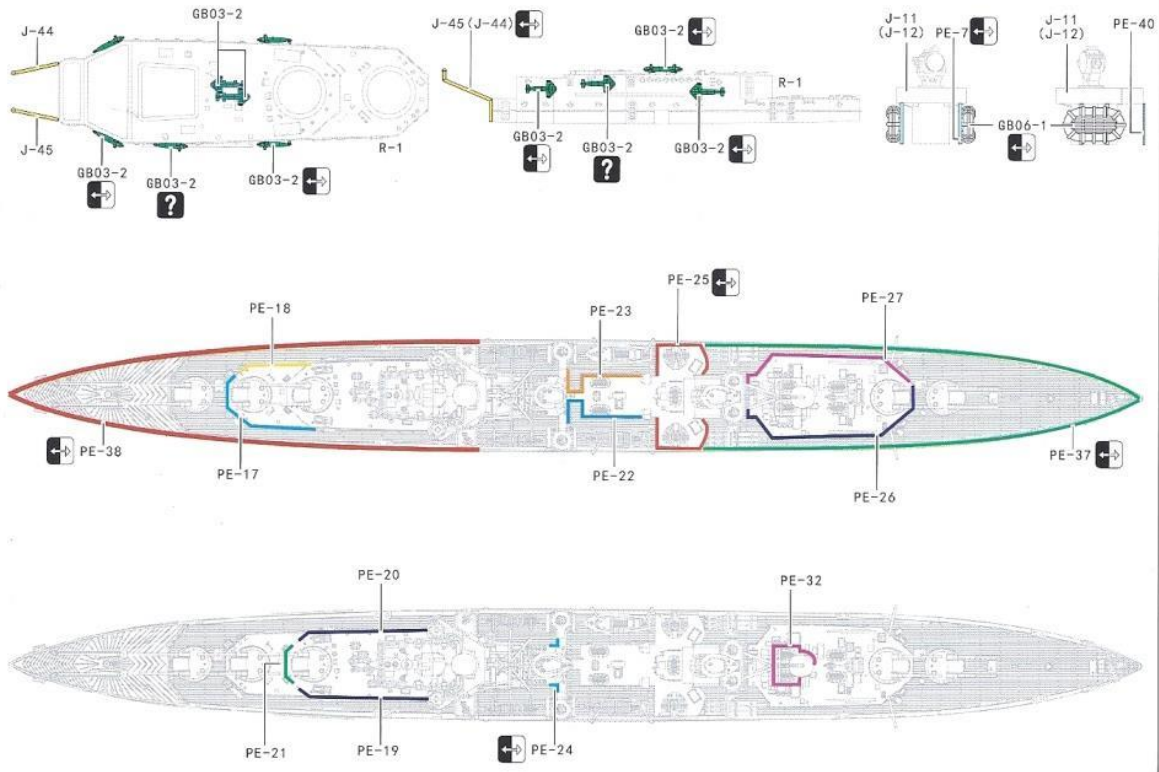

----- Instructions -----

Limited Edition Parts:



----- Limited edition components -----

The limited edition comes with 46 machined metal pieces, 2 additional photo-etch sheets of 364 parts, and rigging thread.

The metal parts consist of depth charges, barrels, bollards, crane booms, kingposts, and brass barrels for the 5.25" guns, all with an amazing degree of precision machining. Most modellers will have no problems with the booms, kingposts, and brass barrels but extra care will be needed for the other metal parts as they are quite small.

The additional 2 photo-etch sheets contain (among other things) a forward breakwater, doors, davits, platforms, porthole details, cable reels, grilles, anchors, depth charge racks, and masthead rigging. There are even 6 rather whimsical benches to be placed on the main decks. I am not sure about their authenticity, but they will certainly add flair to the finished model!

The rigging is very fine synthetic line wrapped around a cardboard piece.

A double sided instruction sheet in full colour indicates where the new pieces are to be placed.

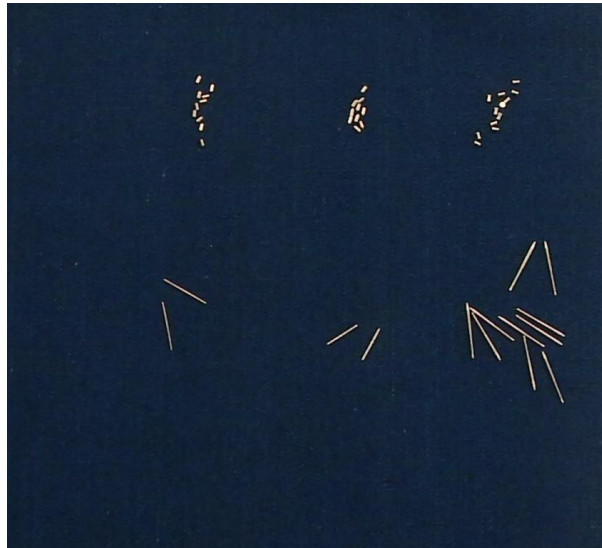

----- Limited edition metal parts -----

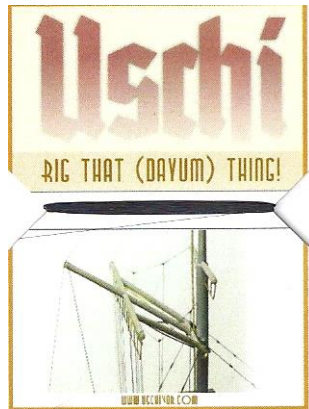

----- Limited edition rigging thread -----



Flyhawk 1/700 HMS NAIAD 1940 A FH 1112S

Made in China www.flyhawkmodel.com

Flyhawk 1/700 HMS NAIAD 1940 B FH 1112S

Made in China www.flyhawkmodel.com

----- Limited edition photo-etch sheets -----

FH 1112S
1/700 SCALE

HMS NAIAD 1940

LIMITED VERSION
限量版

英國皇家海軍水中仙女號輕巡洋艦1940
UNASSEMBLED MODEL KIT



● 註銷零件號 (PE Part No.)	□ 原零件號 (Original Part No.)	→ 替換原零件 (Replace Original part)	↔ 另一面相同操作 (Same another side)
✂ 需剪部分切除 (Cut the shadow)	⚠ 鑽孔 (Make Hole)	↶ 折彎 (Sharp Bend)	⦶ 彎圓 (Roll)
❓ 選擇 (Option)	⬇ 挖孔填平 (File Hole)	----- 紅色向上折 (Red up fold)	----- 藍色向下折 (Blue fold down)

推薦使用工具 RECOMMENDED TOOL

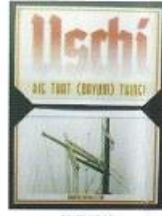
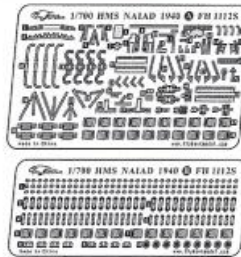

組裝環繞 RIGGING BOBBIN

MB 1 × 10	MB 2 × 10	MB 3 × 12
MB 4 × 2	MB 5 × 2	MB 6 × 10

處理蝕刻片需要您更多的耐心和技術，但經過改造後的模型一定會更加精彩！

Dealing with PE requires more patience and technology, however, models after being upgraded must be more excellent!

フォエッチングを処理するのはあなた様より多くのベーションと技術が必要ですが、改造した後の模型はもっともっと素晴らしいになりますよ！

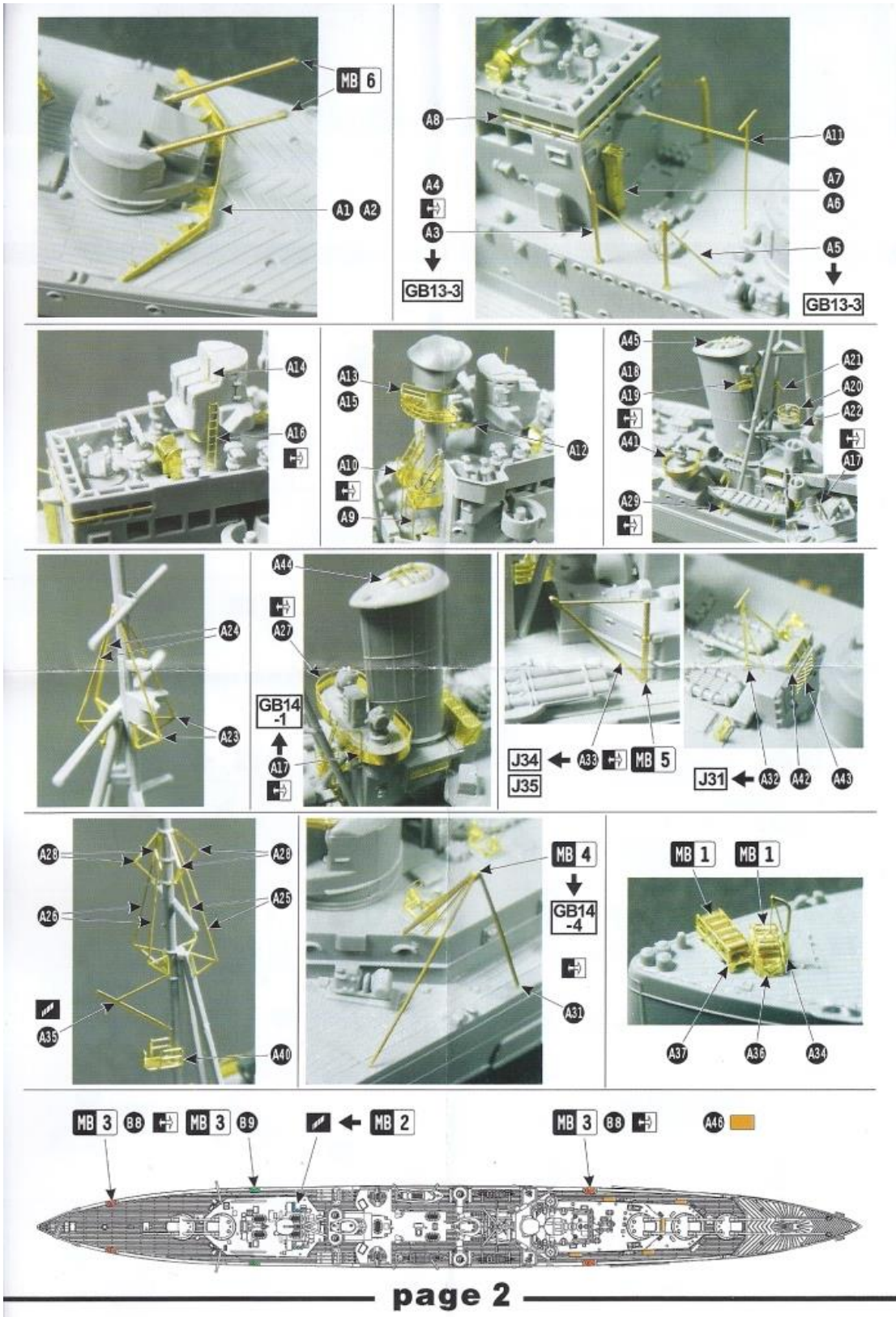

Colour scheme:

There is a full colour diagram of the camouflage scheme carried by *Naiad* from her completion in July 1940 to some point in 1941, with references to the Mr. Colour and Tamiya paint ranges. The brown and green colours appear to be based on the colour drawing featured in the Ensign title 'Dido Class Cruisers' by Alan Raven and H.T. Lenton which shows the starboard side only and states that both sides were the same.

Since the Ensign title was published in 1973, more information has come to light regarding the pattern and the colour scheme. The Warship Perspectives title 'Camouflage Volume One: Royal Navy 1939-1941' by Alan Raven and published in 2000, has a drawing on page 46 showing both sides of *Naiad* wearing essentially the same scheme but with colours of black, 507B, and 507C specified. The two sides are also not identical. To the best of my knowledge, Mr. Raven concedes that this second set of patterns and colours is the definitive version.

The pattern provided by Flyhawk provides yet another interpretation, with the starboard side being very similar to the drawing in the Ensign title and the port side being very similar to the Warship Perspectives drawing. Flyhawk's drawings have some very subtle differences however, and specify the use of green, brown, and light grey.

So the modeller has a choice of colours and patterns to choose from. Royal Navy camouflage still remains a complex subject and for those without access to the newer Warship Perspective drawings, you cannot go too far wrong using the Flyhawk supplied patterns with black, 507B, and 507C.

It should also be noted that *Naiad's* scheme was painted out in favour of the dark hull, light upperworks scheme by September 1941. She was wearing this second scheme when sunk in March 1942.

Painting & Marking guide 涂装与标贴指示

DECAL APPLICATION

1. Cut the pictures from sheet as needed.
2. Dip the pictures in warm water for about 10 seconds.
3. Hold the picture backing sheet edge and gently slide the picture onto the model.
4. Please move the picture to the proper position on model.
5. Please gently press picture down with a soft cloth until excess water's out and no air bubbles.

水贴纸的使用:

1. 从水贴纸上剪下图案;
2. 将图案放入温水中浸泡10秒;
3. 拿着图案纸将图案移到模型上;
4. 将图案移到适当的位置;
5. 用软布轻压图案直至水干, 消除掉气泡。

	Color	颜色	Mr.Hobby	Tamiya
	Flat Black	漆黑黑	H 32 33	XF-1
	Dark Blue-Grey	暗蓝灰	H 32 40	XF-63
	Sky Dark	天灰色	H 308 308	XF-19
	Light Grey	浅灰	H 308 308 2	XF-19:2
			H 11 62 10	XF-2:10
			H 27 44 1	XF-78:1

	Color	颜色	Mr.Hobby	Tamiya
	Hull Red	舰底红	H 17 29	XF-9
	1940 Brown	1940年褐色迷彩	H 47 41	XF-64
	Coppery	铜	H 10 10	XF-6
	Wooden Deck Tan	木甲板色	H 27 44	XF-78
	1940 Green	1940年绿色迷彩		XF-5:2
				XF-2:5

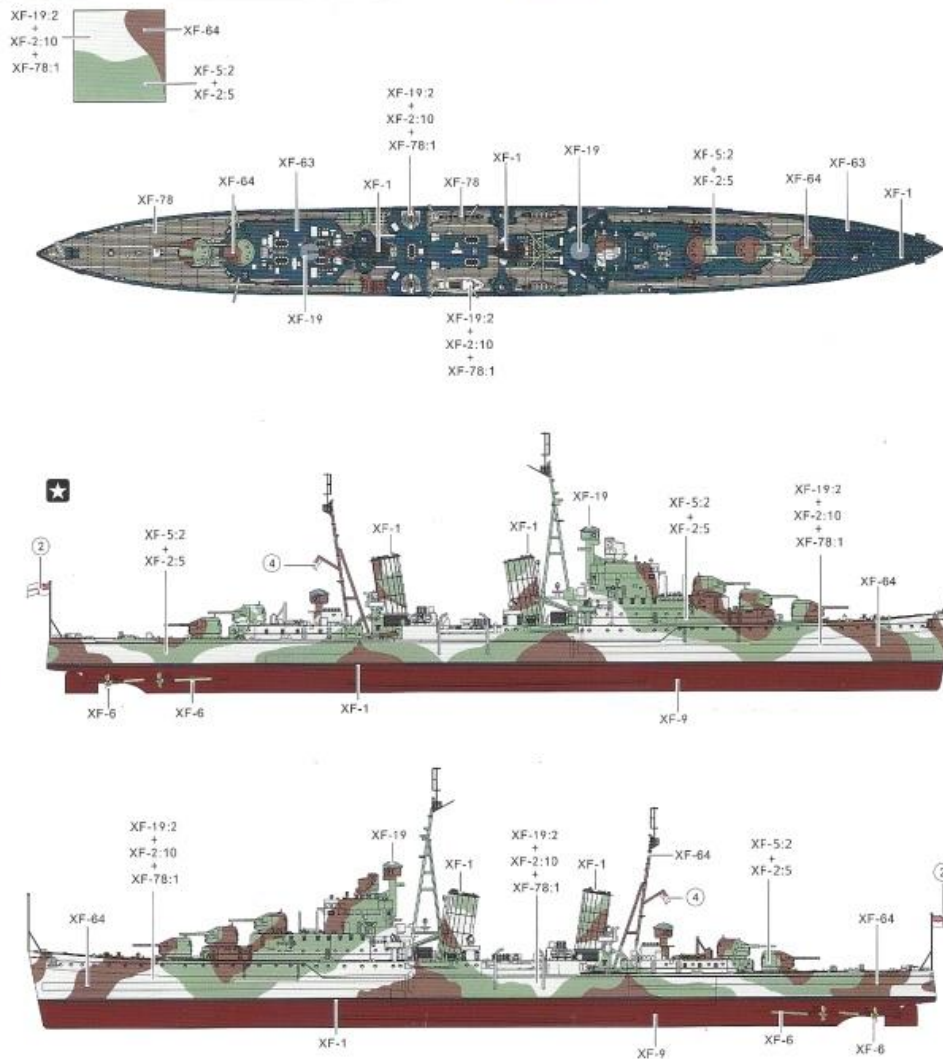

----- Colour scheme -----

Overall Impression:

To put it quite simply, this is a superb kit; it just cries out to be built. The one word that best describes it is 'precision'. All the main superstructure parts fit perfectly when dry fitted. As an example of how precise the components are, all the smaller sprues actually fit together and can be stacked, much like a set of Lego bricks.

It is also very accurate, matching up very well with the drawings and photos in my various reference books. The only thing I would question is the extra gun mount ahead of 'X' turret.

The amount of detail is incredible, considering that the model itself is only 9" long. There is absolutely no flash on any of the pieces and none of those lines that result when two mold halves are used to make a single component. Providing all the main superstructure pieces as separate parts is a brilliant idea, there is very little scope for damage.

It does retail in North America for more than the average kit, but considering that it comes with a dedicated photo-etch set and without much scope for any after-market items, it does represent very good value for the money. In fact, the only thing that could improve this kit would be the provision of anchor chain instead of the photo-etch chain that is provided.

The kit can be used to model any of the 9 members of the first group of *Dido's*, the exceptions being *Scylla* and *Charybdis*. Careful use of references will be required as each ship differed slightly in details.

This is a highly recommended kit, and it will make a splendid addition to any collection. Royal Navy enthusiasts have waited a very long time for an injection molded *Dido* (or any RN cruiser for that matter) in 1/700 and Flyhawk is to be heartily congratulated for providing such a well-researched and well-engineered kit.

The limited edition parts add another level of detail to this already incredible kit. Experienced modellers will appreciate the opportunity for super-detailing, and even those less inclined to super-detailing will find plenty of easily attached parts to dress up the guns, masts, and superstructure. Tracking down one of these limited edition kits will certainly be worthwhile.

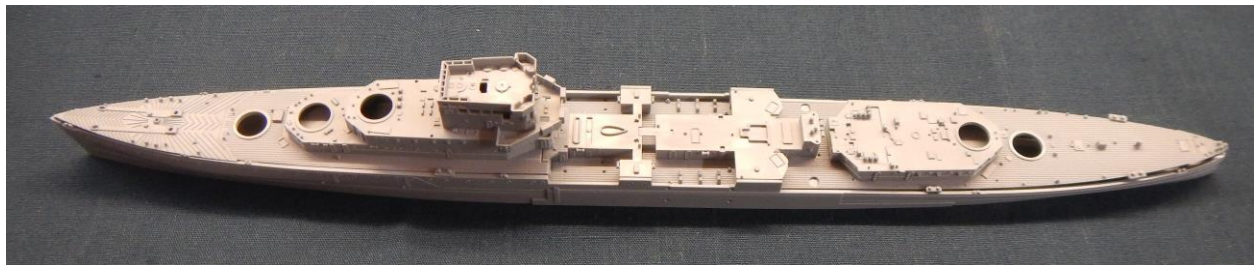

----- *Dry-fitting of decks and main superstructure pieces* -----

Review kit courtesy of Flyhawk Models